

Application: STEP 1

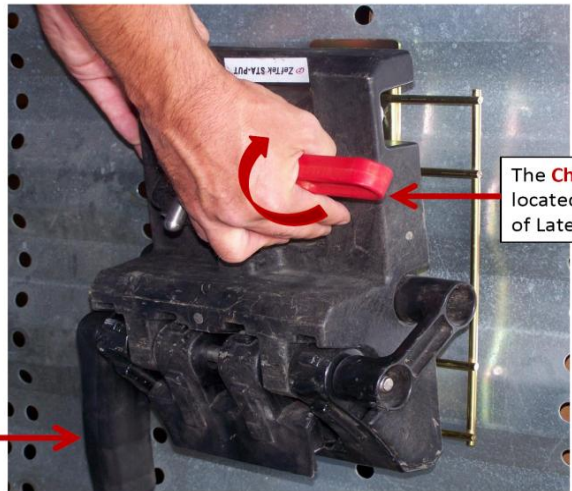

Remove the Sta-Put™ device from the side screen

Step # 1: Holding the *chock release handle*, pull upward to release the Sta-Put™ device from the chock pan.



The **Chock Release Handle** is located on the opposite side of Lateral Restraint.

Lateral Restraint

Application: STEP 4



Disengage the locking pin.

Step # 4: Pull the *release lever* backward to disengage the *locking pin*. Once disengaged, the Sta-Put™ slides easily across the grating.

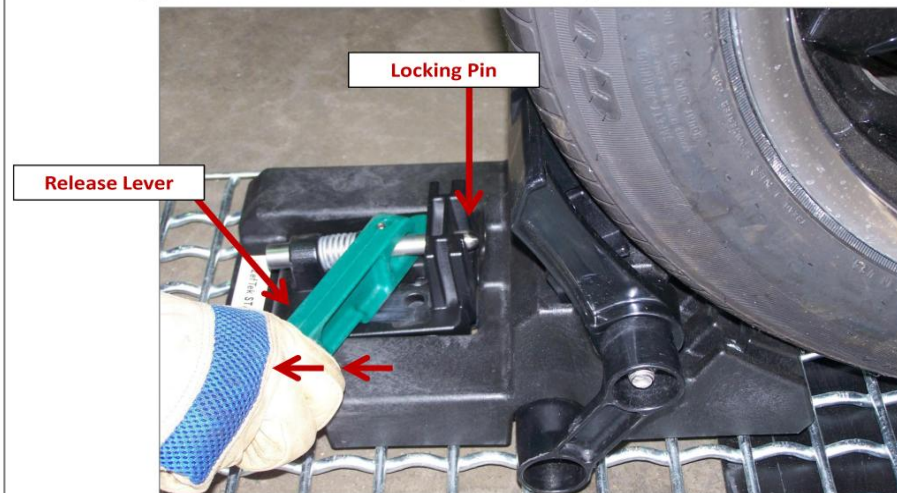

Locking Pin

Release Lever

Application: STEP 6B



Engage the release lever.

Step # 6B: If the locking pin does not easily engage, move the Sta-Put™ back 1/2 of a grating increment. When fully engaged the locking pin will be flush with the rear of the pin housing.

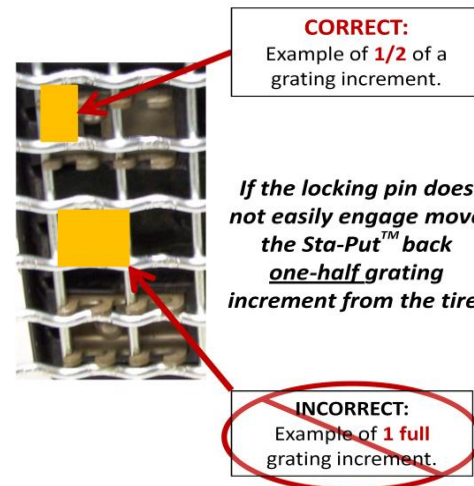

CORRECT: Example of 1/2 of a grating increment.

CORRECT: The locking pin is flush with housing and fully engaged.

INCORRECT: The locking pin extends past housing and is not fully engaged.

INCORRECT: Example of 1 full grating increment.

If the locking pin does not easily engage move the Sta-Put™ back **one-half grating increment from the tire.**

Application: STEP 2



Rotate the Sta-Put™ face plate(s) into position

Step # 2: Rotate the Sta-Put™ face plate(s) into position (High, Medium or Low). Following the vehicle manufacturer and AAR clearance guidelines, set to the highest acceptable position.

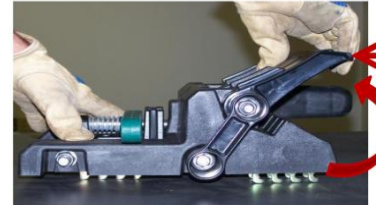

Rotate the **face plate** upward into position.



"High" position: Both the Tall and Short face plates are upright.

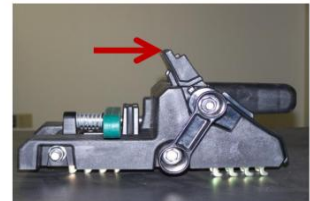

"Medium" position: The Tall face plate is collapsed and the Short face plate is upright.

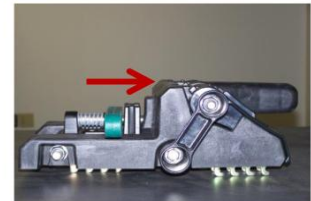

"Low" position: Both the Tall and Short face plates are collapsed.

Application: STEP 5



Position the Sta-Put™ device.

Step # 5: Position the Sta-Put™ against the wheel. Ensure both *face plate(s)* and the *lateral restraint* are seated as close to the wheel as possible.*

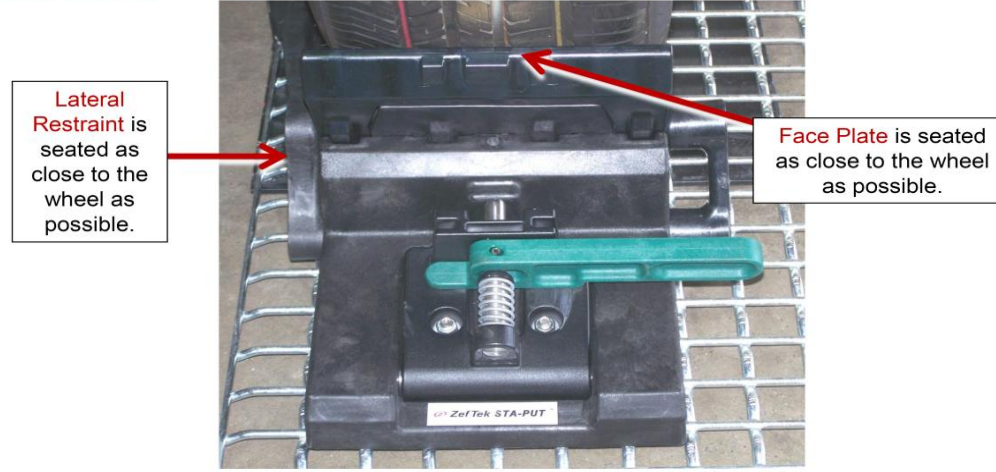

Lateral Restraint is seated as close to the wheel as possible.

Face Plate is seated as close to the wheel as possible.

* AAR Guidelines allow up to 3/4" space between the chock device and the vehicle wheel.

Removal:



Releasing the Sta-Put™ from the grate.

Removal: To release the Sta-Put™ device, **#1** Push the *release lever* away from the wheel with your hand OR foot to disengage the locking pin. **#2** Pull the Sta-Put™ away from the wheel (to release the hooked teeth from the grating). **#3** Lift upward to remove the chock.

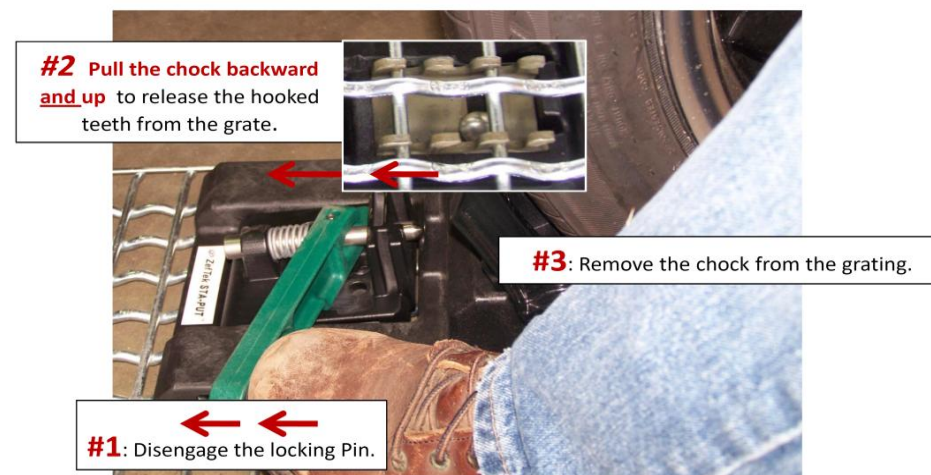

#2 Pull the chock backward and up to release the hooked teeth from the grate.

#3: Remove the chock from the grating.

#1: Disengage the locking Pin.

Application: STEP 3



Placement of the Sta-Put™ Devices (4 per vehicle)

Step # 3: One (1) Sta-Put™ device is placed on the outboard side of **each** wheel. Four(4) devices are required per vehicle as shown below (2 Red, 2 Green).

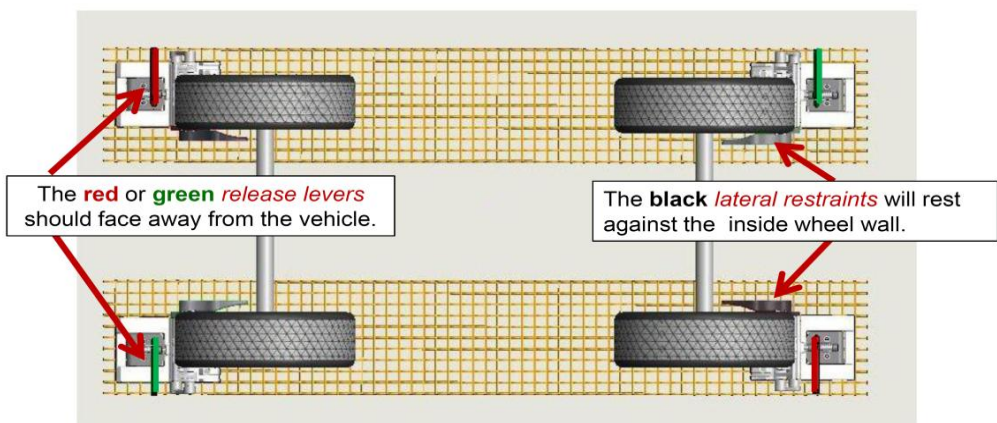

The **red or green release levers** should face away from the vehicle.

The **black lateral restraints** will rest against the inside wheel wall.

Application: STEP 6A



Use the Release Lever to engage the Locking Pin.

Step # 6A: **Push down** or **step on** the black articulating block. Next, push the *release lever* toward the wheel to engage the locking pin.

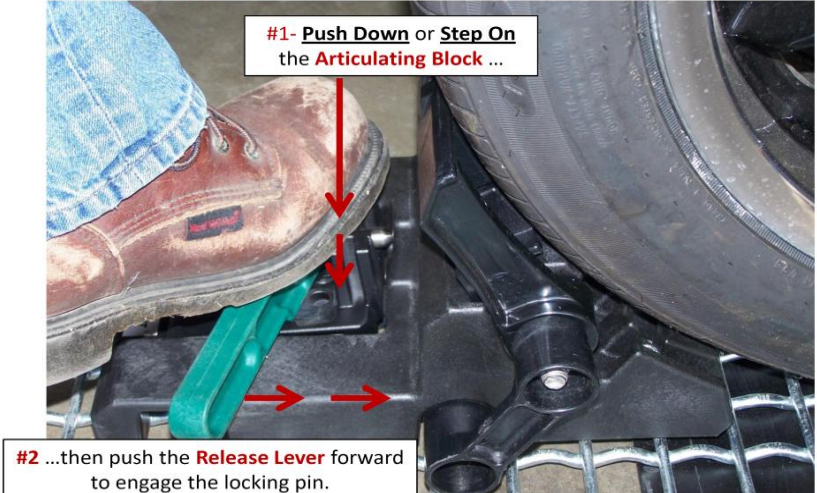

#1- Push Down or Step On the Articulating Block ...

#2 ...then push the **Release Lever** forward to engage the locking pin.

Storage:



Secure the Sta-Put™ to the side screen hanger.

Storage: #1 Pull the face plates upward, then fold to "Low" (or storage position). **#2** With the *Lateral Restraint* toward the deck, engage the *Release Lever* to secure the chock to the side screen storage pan.

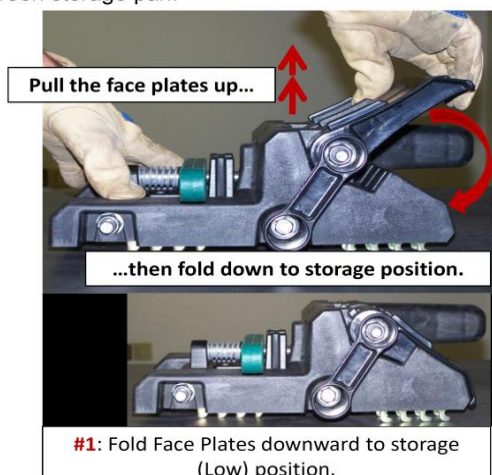

Pull the face plates up...

...then fold down to storage position.

#1: Fold Face Plates downward to storage (Low) position.



Engage the **release lever** to secure the chock to the side screen storage pan.

#2: Secure the Sta-Put™ in the side screen chock pan.